

ELECTRIC REACH TRUCK			SPECIFICATION		
			BALKANCAR RECORD		
1	Manufacturer				
2	Type			ERR 631.42.225T	ERR 634.42.225T
3	Load capacity	Q	kg	1400	1600
4	Load center	C	Load center to fork face	mm	500
5	Drive unit		Battery/diesel/LPG		Battery
9	Lift	h_3	Lift height	mm	4200 ¹⁾
16		l_1	Overall length	mm	2390
17		l_4	Reach travel	mm	500
18		l_7	Length of chassis	mm	1690
19		B	Width	mm	1285
20		h_1	Height, mast lowered	mm	2100
21		h_4	Height, mast extended	mm	4820 ¹⁾
22		h_6	Height of overhead guard	mm	2145
24	Turning radius	W_a	Outer radius	mm	1650
52	Drive control		Type		Impulse regulator

1) For other lift heights refer to MAST table.

* Electric forklifts in accordance with BDS EN 1726-1

* Other variants of specifications, characteristics and batteries are possible.

* Dimensions and parameters as shown are for reference only. They have been obtained under laboratory testing conditions. They could vary in accordance with the operation mode and the corresponding variants.

* Balkancar Rekord JSC reserves the right to introduce changes to the specifications and products without notice.

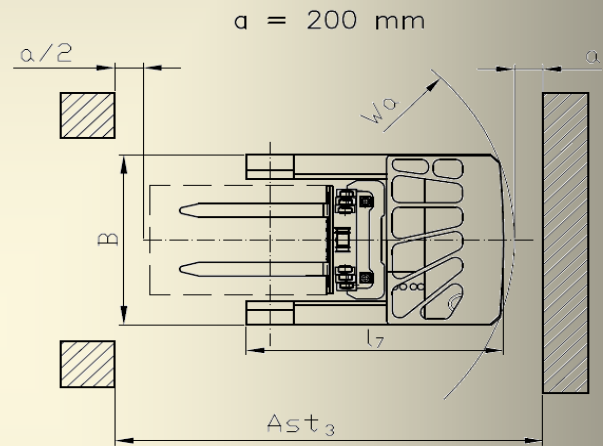
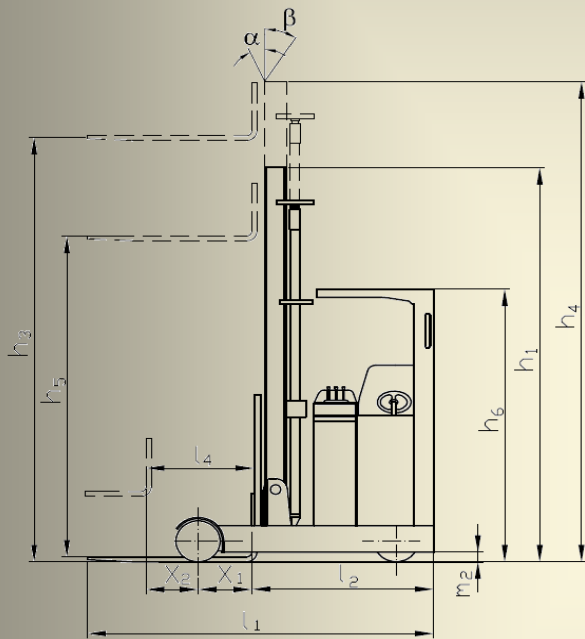

MAST				
TYPE	LIFT HEIGHT h_3	HEIGHT, MAST LOWERED h_1	HEIGHT, MAST EXTENDED h_4	FREE LIFT h_2/h_5

TRIPLEX – 1,4 t ELECTRIC REACH TRUCK
(Three masts, Extended free lift)

42 T	4200	2100	4820	1480
45 T	4500	2240	5240	1600
48 T	4800	2310	5450	1660
52 T	5200	2440	5840	1800
56 T	5600	2590	6290	1940
64 T	6400	2840	7040	2200
90 T**	9000	3690	9735	3100

TRIPLEX – 1,6 t ELECTRIC REACH TRUCK
(Three masts, Extended free lift)

42 T	4200	2100	4820	1480
45 T	4500	2240	5240	1600
48 T	4800	2310	5450	1660
52 T	5200	2440	5840	1800
56 T	5600	2590	6290	1940
64 T*	6400	2840	7040	2200
90 T**	9000	3690	9735	3100

* In lift height - $h_3=6400$ mm - maximum load is $Q=1400$ kg.

** In lift height - $h_3=9000$ mm - maximum load is $Q=1000$ kg.